

Evolution

FIRE FIGHTING • PPE • GAS CYLINDER

Aluminum & Steel Gas Cylinder



Evolution History

1997

World-Safety Inc. was established in Zhejiang, China, Produce all kinds of valves at the beginning.

2006

The 2rd generation Leo.Ho joined in the company to greatly expand the fire extinguishers business abroad.

2016

Leo.Ho Set up the Evolution Ltd.and acquisition of World-Safety Inc.brand and assets.

2019

All Fire Extinguishers approved EN3-7 from Apragaz and NF.

2020

New production line for covid products. ffp2 mask approved Bsi and Prs.sold on-line(B2C) in EU market approx.40 mils of ffp2 mask and 10 mils of covid test between 2020 to 2022.Evolution Team accumulated a strong on-line business ability.

2021

It was a strategic turning point in Evolution's history,as Evolution acquired 49% of Nanjing Banqiao Fire Fighting Equipment Co.,Ltd.(BX Fire),the one who is the first factory produce high pressure cylinder in china from 1994.

2023

Now our main business:
Fire Fighting / PPE / Gas Cylinder

28 1.5 51

Years Experience

Millions Capacity

Certificates





BXFIRE

BX FIRE has formally integrated into EvolutionFire Ltd.effective from Dec 31th 2021.

BXFIRE History

Nanjing Banqiao Fire-Fighting Equipment Co.,Ltd.(BXFIRE) was founded in 1995,it's the 1st factory produce CO2 FireExtinguishers in China.

The factory covers an area of 65000 square workshop,the annual productive capacity is 1.5 million sets of CO2 fire extinguishers.

All products are approved CE from TUV.

What are the benefits of the integration for our customers?

By uniting the capabilities and resources of BX FIRE and Evolution as a consolidated entity,we can now offer a more range of FireExtinguishers,not CO2 FireExtinguishers only.

All FireExtinguishers are approved EN3 from Apragaz,NF and BSI,as well as MED from Apragaz.

What will change and what will stay the same ?

The production address will be the same.

The certificate of gas cylinder will be still under the company "BX Fire".

The mail address keep @BXfire.com or @EvolutionSafe.com

The BX Fire website(www.BXfire.com) have migrated to www.EvolutionCylinder.com

Contact info.:

info@EvolutionSafe.com

BXfire@BXfire.com

+86 137 3840 4444

+86 574 625 22288

TABLE OF CONTENTS



FIRE FIGHTING • PPE • GAS CYLINDER

Fire Extinguisher

<input type="checkbox"/>	GasCylinder-Refillable-Aluminum-PED BS5045 (T1)	01
<input type="checkbox"/>	GasCylinder-Refillable-Aluminum-DOT 3AL (T1)	01
<input type="checkbox"/>	GasCylinder-Refillable-Steel-PED 9809-1 (T1)	02
<input type="checkbox"/>	GasCylinder-Refillable-Steel-TPED 9809-1 (T1)	02

Fire Suppression

<input type="checkbox"/>	GasCylinder-Refillable-Steel-TPED 9809-1 (T1)	03/04
--------------------------	---	-------

Industrial & Specialty

<input type="checkbox"/>	GasCylinder-Refillable-Aluminum-TPED 7866 (T1)	05
<input type="checkbox"/>	GasCylinder-Refillable-Aluminum-DOT 3AL (T1)	06
<input type="checkbox"/>	GasCylinder-Refillable-Steel-TPED 9809-1 (T1)	07

Beverage (Carbon Dioxide)

<input type="checkbox"/>	GasCylinder-Refillable-Aluminum-TPED 7866 (T1)	08
<input type="checkbox"/>	GasCylinder-Refillable-Aluminum-DOT 3AL (T1)	09
<input type="checkbox"/>	GasCylinder-Refillable-Steel-TPED 9809-1 (T1)	10

Medical (Oxygen)

<input type="checkbox"/>	GasCylinder-Refillable-Aluminum-TPED 7866 (T1)	11
<input type="checkbox"/>	GasCylinder-Refillable-Aluminum-DOT 3AL (T1)	12
<input type="checkbox"/>	GasCylinder-Refillable-Steel-TPED 9809-1 (T1)	13

SCBA

<input type="checkbox"/>	GasCylinder-Refillable-Aluminum-TPED 7866 (T1)	14
<input type="checkbox"/>	GasCylinder-Refillable-Aluminum-DOT 3AL (T1)	14
<input type="checkbox"/>	GasCylinder-Refillable-Steel-TPED 9809-1 (T1)	15

SCUBA

<input type="checkbox"/>	GasCylinder-Refillable-Aluminum-TPED 7866 (T1)	16
<input type="checkbox"/>	GasCylinder-Refillable-Aluminum-DOT 3AL (T1)	17
<input type="checkbox"/>	GasCylinder-Refillable-Steel-TPED 9809-1 (T1)	18

Paintball

<input type="checkbox"/>	GasCylinder-Refillable-Aluminum-TPED 7866 (T1)	19
<input type="checkbox"/>	GasCylinder-Refillable-Aluminum-DOT 3AL (T1)	20

Nitrous Oxide (Performance Racing)

<input type="checkbox"/>	GasCylinder-Refillable-Aluminum-TPED 7866 (T1)	21
<input type="checkbox"/>	GasCylinder-Refillable-Aluminum-DOT 3AL (T1)	21
<input type="checkbox"/>	GasCylinder-Refillable-Steel-TPED 9809-1 (T1)	22





Refillable PED & DOT Aluminum Gas Cylinder (T1) Fire Extinguisher

FOLLOW US ON   

- Approval: PED & DOT
- Standard: PED BS5045 & DOT-3AL
- Material: AA 6061
- Thread: Follow Technical Data Sheet(EVO-THREAD)
- Finish: Full Brushed/Polished/Powder Coat/Shot blaster with unpainted or painted crown
- Graphics: Labels and logos available upon request
- Valve: Valves installed upon request
- Note: Custom sizes are also available
or check our "Summary of Refillable Aluminum Gas Cylinder by Standard" for more size



PED BS5045

SKU	CO2 Capacity		Water Capacity			Diameter		Length		Service Pressure		Weight	
	kgs	lbs	liters	cu in	lbs	mm	in	mm	in	bar	psi	kgs	lbs
EVO-LW-111-3.00-174-H	2.00	4.40	3.00	183.07	6.60	111	4.37	459	18.07	174	2523	2.79	6.14
EVO-LW-117-3.00-174-H	2.00	4.40	3.00	183.07	6.60	117	4.61	421	16.57	174	2523	2.87	6.31
EVO-LW-152-7.50-174-H	5.00	11.00	7.50	457.68	16.50	152	5.98	601	23.66	174	2523	6.75	14.85
EVO-LW-111-3.00-169.3-H	2.00	4.40	3.00	183.07	6.60	111	4.37	447	17.60	169.3	2455	2.44	5.37
EVO-LW-140-5.25-169.3-H	3.50	7.70	5.25	320.37	11.55	140	5.51	491	19.33	169.3	2455	4.27	9.39
EVO-LW-152-7.50-169.3-H	5.00	11.00	7.50	457.68	16.50	152	5.98	585	23.03	169.3	2455	5.91	13.00

DOT-3AL

SKU	CO2 Capacity		Water Capacity			Diameter		Length		Service Pressure		Weight	
	kgs	lbs	liters	cu in	lbs	mm	in	mm	in	bar	psi	kgs	lbs
EVO-LW-133-3.40-1800-DOT	2.27	5.00	3.40	207.48	7.48	133	5.24	360	14.17	124	1800	3.09	6.80
EVO-LW-175-6.70-1800-DOT	4.55	10.00	6.70	408.86	14.74	175	6.89	425	16.73	124	1800	6.38	14.04
EVO-LW-175-10.00-1800-DOT	6.82	15.00	10.00	610.24	22.00	175	6.89	596	23.46	124	1800	8.31	18.28
EVO-LW-203-13.40-1800-DOT	9.09	20.00	13.40	817.72	29.48	203	7.99	600	23.62	124	1800	11.38	25.04

NINGBO EVOLUTION FIRE SAFETY EQUIPMENT CO., LTD.

ADDRESS

NO.2 TENGJIAO RD., ECONOMIC DEVELOPMENT ZONE,
YUYAO, ZHEJIANG, 315400, P.R.CHINA



+86 137 3840 4444



+86 574 6252 2288



info@EvolutionSafe.com



EvolutionCylinder.com

Refillable PED Steel Gas Cylinder (T1) Fire Extinguisher

FOLLOW US ON



- Approval: PED from TUV SUD
- Standard: ISO 9809-1
- Material: 34CrMo4
- Thread: Follow Technical Data Sheet(EVO-THREAD)
- Finish: Polished/Powder Coat/Shot blaster with unpainted or painted crown
- Graphics: Labels and logos available upon request
- Valve: Valves installed upon request
- Accessories: Carrying handle, Caps&Collars are available upon request
- Note: Custom sizes are also available
or check our "Summary of Refillable Steel Gas Cylinder by Standard" for more size



PED ISO 9809-1



SKU	CO2 Capacity		Water Capacity			Diameter		Length		Service Pressure		Weight	
	kgs	lbs	liters	cuin	lbs	mm	in	mm	in	bar	psi	kgs	lbs
BXP104-3.00-250-2.29-A	2	4.40	3.00	183.07	6.60	104	4.09	480	18.90	174	2523	3.78	8.32
BXP104-3.00-250-2.29-TB	2	4.40	3.00	183.07	6.60	104	4.09	490	19.29	174	2523	4.00	8.80
BXP116-3.00-250-2.38-A	2	4.40	3.00	183.07	6.60	116	4.57	384	15.12	174	2523	3.81	8.38
BXP116-4.50-250-2.38-A	3	6.60	4.50	274.61	9.90	116	4.57	540	21.26	174	2523	4.76	10.47
BXP136-7.50-250-2.78-A	5	11.00	7.50	457.68	16.50	136	5.35	655	25.79	174	2523	7.82	17.20
BXP136-7.50-250-2.78-TB	5	11.00	7.50	457.68	16.50	136	5.35	670	26.38	174	2523	8.28	18.22
BXP154-10.50-250-3.14-A	7	15.40	10.50	640.75	23.10	154	6.06	698	27.48	174	2523	10.63	23.39
BXP154-10.50-250-3.14-TB	7	15.40	10.50	640.75	23.10	154	6.06	720	28.35	174	2523	11.36	24.99
BXP154-15.00-250-3.14-A	10	22.00	15.00	915.36	33.00	154	6.06	975	38.39	174	2523	13.95	30.69
BXP154-15.00-250-3.14-TB	10	22.00	15.00	915.36	33.00	154	6.06	985	38.78	174	2523	14.69	32.32
BXP104-2.67-315-2.55-A	2	4.40	2.67	162.93	5.87	104	4.09	440	17.32	216.1	3133.5	3.54	7.79
BXP104-2.67-315-2.55-TB	2	4.40	2.67	162.93	5.87	104	4.09	445	17.52	216.1	3133.5	3.74	8.23
BXP116-2.67-315-2.58-A	2	4.40	2.67	162.93	5.87	116	4.57	365	14.37	216.1	3133.5	3.86	8.49
BXP116-2.67-315-2.58-TB	2	4.40	2.67	162.93	5.87	116	4.57	365	14.37	216.1	3133.5	3.92	8.62
BXP116-4.00-315-2.58-A	3	6.60	4.00	244.10	8.80	116	4.57	490	19.29	216.1	3133.5	4.42	9.72
BXP116-4.00-315-2.58-TB	3	6.60	4.00	244.10	8.80	116	4.57	494	19.45	216.1	3133.5	4.78	10.52
BXP136-6.67-315-3.01-A	5	11.00	6.67	407.03	14.67	136	5.35	593	23.35	216.1	3133.5	7.81	17.18
BXP136-6.67-315-3.01-TB	5	11.00	6.67	407.03	14.67	136	5.35	603	23.74	216.1	3133.5	8.61	18.94
BXP154-9.34-315-3.40-A	7	15.40	9.34	569.96	20.55	154	6.06	631	24.84	216.1	3133.5	10.20	22.44
BXP154-9.34-315-3.40-TB	7	15.40	9.34	569.96	20.55	154	6.06	650	25.59	216.1	3133.5	11.44	25.17
BXP140-13.40-315-3.07-A	10	22.00	13.40	817.72	29.48	140	5.51	1041	40.98	216	3132	12.90	28.38

TPED ISO 9809-1



SKU	CO2 Capacity		Water Capacity			Diameter		Length		Service Pressure		Weight	
	kgs	lbs	liters	cuin	lbs	mm	in	mm	in	bar	psi	kgs	lbs
BXT154-15.00-166.7-3.14-A	10	22.00	15.00	915.36	33.00	154	6.06	975	38.39	166.7	2418	13.95	30.69

NINGBO EVOLUTION FIRE SAFETY EQUIPMENT CO., LTD.

ADDRESS

NO.2 TENGJIAO RD., ECONOMIC DEVELOPMENT ZONE,
YUYAO, ZHEJIANG, 315400, P.R.CHINA



+86 137 3840 4444



+86 574 6252 2288



info@EvolutionSafe.com



EvolutionCylinder.com



Refillable TPED Steel Gas Cylinder (T1) Fire Suppression

FOLLOW US ON   

- Approval: TPED from TUV SUD
- Standard: ISO 9809-1
- Material: 34CrMo4
- Thread: Follow Technical Data Sheet(EVO-THREAD)
- Finish: Polished/Powder Coat/Shot blaster with unpainted or painted crown
- Graphics: Labels and logos available upon request
- Valve: Valves installed upon request
- Accessories: Carrying handle, Caps&Collars are available upon request
- Note: Custom sizes are also available
or check our "Summary of Refillable Steel Gas Cylinder by Standard" for more size



TPED ISO 9809-1 

SKU	Water Capacity			Diameter		Length		Service Pressure		CO2 Capacity		Weight	
	liters	cuin	lbs	mm	in	mm	in	bar	psi	kgs	lbs	kgs	lbs
BXT104-1.80-210-2.55-A	1.80	109.84	3.96	104	4.09	314	12.36	210	3045	1.35	2.97	2.94	6.47
BXT104-2.00-210-2.55-A	2.00	122.05	4.40	104	4.09	342	13.46	210	3045	1.50	3.30	3.08	6.78
BXT104-2.10-210-2.55-A	2.10	128.15	4.62	104	4.09	356	14.02	210	3045	1.57	3.45	3.14	6.91
BXT104-2.90-210-2.55-A	2.90	176.97	6.38	104	4.09	468	18.43	210	3045	2.17	4.77	3.62	7.96
BXT116-2.90-210-2.58-A	2.90	176.97	6.38	116	4.57	376	14.80	210	3045	2.17	4.77	3.91	8.60
BXT104-3.00-210-2.55-A	3.00	183.07	6.60	104	4.09	475	18.70	210	3045	2.25	4.95	3.79	8.34
BXT116-3.00-210-2.58-A	3.00	183.07	6.60	116	4.57	387	15.24	210	3045	2.25	4.95	3.96	8.71
BXT104-4.00-210-2.55-A	4.00	244.10	8.80	104	4.09	608	23.94	210	3045	3.00	6.60	4.49	9.88
BXT116-4.00-210-2.58-A	4.00	244.10	8.80	116	4.57	490	19.29	210	3045	3.00	6.60	4.42	9.72
BXT104-4.30-210-2.55-A	4.30	262.40	9.46	104	4.09	648	25.51	210	3045	3.20	7.04	4.70	10.34
BXT116-4.30-210-2.58-A	4.30	262.40	9.46	116	4.57	520	20.47	210	3045	3.20	7.04	4.55	10.01
BXT136-4.30-210-3.01-A	4.30	262.40	9.46	136	5.35	414	16.30	210	3045	3.20	7.04	6.06	13.33
BXT104-4.35-210-2.55-A	4.35	265.45	9.57	104	4.09	655	25.79	210	3045	3.26	7.17	4.74	10.43
BXT116-4.35-210-2.58-A	4.35	265.45	9.57	116	4.57	526	20.71	210	3045	3.26	7.17	4.58	10.08
BXT136-4.35-210-3.01-A	4.35	265.45	9.57	136	5.35	431	16.97	210	3045	3.26	7.17	6.09	13.40

NINGBO EVOLUTION FIRE SAFETY EQUIPMENT CO., LTD.

ADDRESS

NO.2 TENGJIAO RD., ECONOMIC DEVELOPMENT ZONE,
YUYAO, ZHEJIANG, 315400, P.R.CHINA



+86 137 3840 4444



+86 574 6252 2288



info@EvolutionSafe.com



EvolutionCylinder.com

Refillable TPED Steel Gas Cylinder (T1)

Fire Suppression

TPED ISO 9809-1

SKU	Water Capacity			Diameter		Length		Service Pressure		CO2 Capacity		Weight	
	liters	cuin	lbs	mm	in	mm	in	bar	psi	kgs	lbs	kgs	lbs
BXT116-5.00-210-2.58-A	5.00	305.12	11.00	116	4.57	601	23.66	210	3045	3.70	8.14	4.88	10.74
BXT136-5.00-210-3.01-A	5.00	305.12	11.00	136	5.35	466	18.35	210	3045	3.70	8.14	6.45	14.19
BXT140-5.00-300-4.50-T	5.00	305.12	11.00	140	5.51	462	18.19	300	4350	3.70	8.14	8.20	18.04
BXT136-6.00-210-3.01-A	6.00	366.14	13.20	136	5.35	542	21.34	210	3045	4.50	9.90	7.31	16.08
BXT136-6.70-210-3.01-A	6.70	408.86	14.74	136	5.35	595	23.43	210	3045	5.00	11.00	7.83	17.23
BXT154-6.70-166.7-3.14-A	6.70	408.86	14.74	154	6.06	479	18.86	166.7	2418	4.50	9.90	8.12	17.86
BXT136-8.00-210-3.01-A	8.00	488.19	17.60	136	5.35	693	27.28	210	3045	6.00	13.20	8.73	19.21
BXT154-8.00-210-3.40-A	8.00	488.19	17.60	154	6.06	562	22.13	210	3045	6.00	13.20	9.21	20.26
BXT154-8.00-166.7-3.14-A	8.00	488.19	17.60	154	6.06	557	21.93	166.7	2418	5.40	11.88	9.03	19.87
BXT154-8.47-166.7-3.14-A	8.47	516.87	18.63	154	6.06	585	23.03	166.7	2418	5.70	12.54	9.36	20.59
BXT136-10.00-210-3.01-A	10.00	610.24	22.00	136	5.35	844	33.23	210	3045	7.50	16.50	10.27	22.59
BXT154-10.00-210-3.40-A	10.00	610.24	22.00	154	6.06	688	27.09	210	3045	7.50	16.50	10.83	23.83
BXT154-10.00-166.7-3.14-A	10.00	610.24	22.00	154	6.06	676	26.61	166.7	2418	6.75	14.85	10.43	22.95
BXT154-13.40-210-3.40-A	13.40	817.72	29.48	154	6.06	888	34.96	210	3045	10.00	22.00	13.34	29.35
BXT154-13.40-166.7-3.14-A	13.40	817.72	29.48	154	6.06	879	34.61	166.7	2418	9.00	19.80	12.81	28.18
BXT154-14.00-210-3.40-A	14.00	854.33	30.80	154	6.06	923	36.34	210	3145	10.50	23.10	13.79	30.34
BXT154-14.00-166.7-3.14-A	14.00	854.33	30.80	154	6.06	915	36.02	166.7	2418	9.45	20.79	13.24	29.13
BXP140-13.40-216-3.07-A	13.40	817.72	29.48	140	5.51	1041	40.98	216	3132	10.00	22.00	12.90	28.38



NINGBO EVOLUTION FIRE SAFETY EQUIPMENT CO., LTD.

ADDRESS

NO.2 TENGJIAO RD., ECONOMIC DEVELOPMENT ZONE,
YUYAO, ZHEJIANG, 315400, P.R.CHINA



+86 137 3840 4444



+86 574 6252 2288



info@EvolutionSafe.com



EvolutionCylinder.com

Refillable TPED Aluminum Gas Cylinder (T1) Industrial & Specialty

FOLLOW US ON   

- Approval: TPED from TÜV Rheinland
- Standard: ISO 7866
- Material: AA 6061
- Thread: Follow Technical Data Sheet(EVO-THREAD)
- Finish: Full Brushed/Polished/Powder Coat/Shot blaster with unpainted or painted crown
- Graphics: Labels and logos available upon request
- Valve: Valves installed upon request
- Accessories: Carrying handle, Caps&Collars are available upon request
- Note: Custom sizes are also available
or check our "Summary of Refillable Aluminum Gas Cylinder by Standard" for more size



TPED ISO 7866  TÜVRheinland®

SKU	Water Capacity			Diameter		Length		Service Pressure		Nitrogen Capacity		Weight	
	liters	cuin	lbs	mm	in	mm	in	bar	psi	liters	cuft	kgs	lbs
LW60-0.40-166-TPED	0.40	24.41	0.88	60.0	2.36	240	9.45	166	2407	65.50	2.31	0.46	1.01
LW60-0.50-166-TPED	0.50	30.51	1.10	60.0	2.36	286	11.26	166	2407	81.90	2.89	0.54	1.19
LW90-0.80-166-TPED	0.80	48.82	1.76	90.0	3.54	228	8.98	166	2407	131.10	4.63	1.10	2.42
LW90-1.00-166-TPED	1.00	61.02	2.20	90.0	3.54	270	10.63	166	2407	163.80	5.78	1.27	2.79
LW90-1.50-166-TPED	1.50	91.54	3.30	90.0	3.54	375	14.76	166	2407	245.70	8.67	1.69	3.72
LW120-2.00-166-TPED	2.00	122.05	4.40	120.0	4.72	303	11.93	166	2407	327.70	11.57	2.69	5.92
LW120-2.67-166-TPED	2.67	162.93	5.87	120.0	4.72	381	15.00	166	2407	437.40	15.44	3.24	7.13
LW120-3.00-166-TPED	3.00	183.07	6.60	120.0	4.72	419	16.50	166	2407	491.50	17.35	3.51	7.72
LW140-5.00-166-TPED	5.00	305.12	11.00	140.0	5.51	496	19.53	166	2407	819.10	28.91	5.47	12.03
LW203-13.40-166-TPED	13.40	817.72	29.48	203.0	7.99	642	25.28	166	2407	2195.30	77.49	14.42	31.72
LW203-14.00-166-TPED	14.00	854.33	30.80	203.0	7.99	666	26.22	166	2407	2293.60	80.96	14.89	32.76
LW203-15.00-166-TPED	15.00	915.36	33.00	203.0	7.99	706	27.80	166	2407	2457.40	86.75	15.67	34.47
LW203-16.00-166-TPED	16.00	976.38	35.20	203.0	7.99	746	29.37	166	2407	2621.30	92.53	16.44	36.17
LW203-17.00-166-TPED	17.00	1037.40	37.40	203.0	7.99	786	30.94	166	2407	2785.10	98.31	17.22	37.88
LW203-18.00-166-TPED	18.00	1098.43	39.60	203.0	7.99	826	32.52	166	2407	2948.90	104.10	18.00	39.60
LW203-19.00-166-TPED	19.00	1159.45	41.80	203.0	7.99	866	34.09	166	2407	3112.80	109.88	18.78	41.32
LW203-20.00-166-TPED	20.00	1220.48	44.00	203.0	7.99	906	35.67	166	2407	3276.60	115.66	19.56	43.03

NINGBO EVOLUTION FIRE SAFETY EQUIPMENT CO., LTD.

ADDRESS

NO.2 TENGJIAO RD., ECONOMIC DEVELOPMENT ZONE,
YUYAO, ZHEJIANG, 315400, P.R.CHINA



+86 137 3840 4444



+86 574 6252 2288



info@EvolutionSafe.com



EvolutionCylinder.com

Refillable DOT Aluminum Gas Cylinder (T1) Industrial & Specialty

FOLLOW US ON



- Approval: DOT
- Standard: DOT-3AL
- Material: AA 6061
- Thread: Follow Technical Data Sheet(EVO-THREAD)
- Finish: Full Brushed/Polished/Powder Coat/Shot blaster with unpainted or painted crown
- Graphics: Labels and logos available upon request
- Valve: Valves installed upon request
- Accessories: Carrying handle, Caps&Collars are available upon request
- Note: Custom sizes are also available
or check our "Summary of Refillable Aluminum Gas Cylinder by Standard" for more size



DOT-3AL  U.S. Department of Transportation

SKU	Water Capacity			Diameter		Length		Service Pressure		Nitrogen Capacity		Weight	
	liters	cuin	lbs	mm	in	mm	in	bar	psi	liters	cuft	kgs	lbs
LF-81.5-2216-0.70-DOT	0.70	42.72	1.54	81.5	3.21	240	9.45	153	2216	105.70	3.73	0.88	1.94
LF-81.5-2216-1.00-DOT	1.00	61.02	2.20	81.5	3.21	310	12.20	153	2216	151.00	5.33	1.09	2.40
LF-111.3-2015-1.40-DOT	1.40	85.43	3.08	111.3	4.38	240	9.45	139	2015	192.10	6.78	1.73	3.81
LF-111.3-2015-1.70-DOT	1.70	103.74	3.74	111.3	4.38	279	10.98	139	2015	233.20	8.23	1.93	4.25
LF-133.4-2216-3.90-DOT	3.90	237.99	8.58	133.4	5.25	430	16.93	153	2216	588.90	20.79	4.10	9.02
LF-133.4-2216-4.00-DOT	4.00	244.10	8.80	133.4	5.25	439	17.28	153	2216	604.00	21.32	4.17	9.17
LF-133.4-2216-4.55-DOT	4.55	277.66	10.01	133.4	5.25	489	19.25	153	2216	687.00	24.25	4.58	10.08
LF-133.4-2216-5.90-DOT	5.90	360.04	12.98	133.4	5.25	614	24.17	153	2216	890.90	31.45	5.66	12.45

NINGBO EVOLUTION FIRE SAFETY EQUIPMENT CO., LTD.

ADDRESS

NO.2 TENGJIAO RD., ECONOMIC DEVELOPMENT ZONE,
YUYAO, ZHEJIANG, 315400, P.R.CHINA



+86 137 3840 4444



+86 574 6252 2288



info@EvolutionSafe.com



EvolutionCylinder.com



Refillable TPED Steel Gas Cylinder (T1) Industrial & Specialty

FOLLOW US ON   

- Approval: TPED from TUV SUD
- Standard: ISO 9809-1
- Material: 34CrMo4
- Thread: Follow Technical Data Sheet(EVO-THREAD)
- Finish: Polished/Powder Coat/Shot blaster with unpainted or painted crown
- Graphics: Labels and logos available upon request
- Valve: Valves installed upon request
- Accessories: Carrying handle, Caps&Collars are available upon request
- Note: Custom sizes are also available
or check our "Summary of Refillable Steel Gas Cylinder by Standard" for more size



TPED ISO 9809-1 

SKU	Water Capacity			Diameter		Length		Service Pressure		Nitrogen Capacity		Weight	
	liters	cuin	lbs	mm	in	mm	in	bar	psi	liters	cuft	kgs	lbs
BXT104-2.00-210-2.55-A	2.00	122.05	4.40	104	4.09	342	13.46	210	3045	414.50	14.63	3.08	6.78
BXT104-3.00-210-2.55-A	3.00	183.07	6.60	104	4.09	475	18.70	210	3045	621.80	21.95	3.74	8.23
BXT116-3.00-210-2.58-A	3.00	183.07	6.60	116	4.57	387	15.24	210	3045	621.80	21.95	3.96	8.71
BXT116-5.00-210-2.58-A	5.00	305.12	11.00	116	4.57	601	23.66	210	3045	1036.30	36.58	4.88	10.74
BXT136-5.00-210-3.01-A	5.00	305.12	11.00	136	5.35	466	18.35	210	3045	1036.30	36.58	6.45	14.19
BXT140-5.00-300-4.50-T	5.00	305.12	11.00	140	5.51	462	18.19	300	4350	1484.40	52.40	8.20	18.04
BXT136-8.00-210-3.01-A	8.00	488.19	17.60	136	5.35	693	27.28	210	3045	1658.00	58.53	8.73	19.21
BXT140-8.00-300-4.50-T	8.00	488.19	17.60	140	5.51	711	27.99	300	4350	2368.60	83.61	12.55	27.61
BXT154-8.00-210-3.40-A	8.00	488.19	17.60	154	6.06	562	22.13	210	3045	1658.00	58.53	9.21	20.26
BXT154-8.00-166.7-3.14-A	8.00	488.19	17.60	154	6.06	557	21.93	166.7	2418	1316.20	46.46	9.03	19.87
BXT136-10.00-210-3.01-A	10.00	610.24	22.00	136	5.35	844	33.23	210	3045	2072.50	73.16	10.27	22.59
BXT154-10.00-210-3.40-A	10.00	610.24	22.00	154	6.06	688	27.09	210	3045	2072.50	73.16	10.83	23.83
BXT154-10.00-166.7-3.14-A	10.00	610.24	22.00	154	6.06	713	28.07	166.7	2418	1645.20	58.08	10.43	22.95
BXT154-14.00-210-3.40-A	14.00	854.33	30.80	154	6.06	923	36.34	210	3045	2901.60	102.43	13.79	30.34
BXT154-14.00-166.7-3.14-A	14.00	854.33	30.80	154	6.06	915	36.02	166.7	2418	2303.30	81.31	13.24	29.13

NINGBO EVOLUTION FIRE SAFETY EQUIPMENT CO., LTD.

ADDRESS

NO.2 TENGJIAO RD., ECONOMIC DEVELOPMENT ZONE,
YUYAO, ZHEJIANG, 315400, P.R.CHINA



+86 137 3840 4444



+86 574 6252 2288



info@EvolutionSafe.com



EvolutionCylinder.com

Refillable TPED Aluminum Gas Cylinder (T1) Beverage (Carbon Dioxide)

FOLLOW US ON



- Approval: TPED from TUV Rheinland
- Standard: ISO 7866
- Material: AA 6061
- Thread: Follow Technical Data Sheet(EVO-THREAD)
- Finish: Full Brushed/Polished/Powder Coat/Shot blaster with unpainted or painted crown
- Graphics: Labels and logos available upon request
- Valve: Valves installed upon request
- Accessories: Carrying handle, Caps&Collars are available upon request
- Note: Custom sizes are also available
or check our "Summary of Refillable Aluminum Gas Cylinder by Standard" for more size



TPED ISO 7866  TÜVRheinland®

SKU	Water Capacity			Diameter		Length		Service Pressure		CO2 Capacity		Weight	
	liters	cuin	lbs	mm	in	mm	in	bar	psi	kgs	lbs	kgs	lbs
LW60-0.40-166-TPED	0.40	24.41	0.88	60	2.36	240	9.45	166	2407	0.27	0.59	0.46	1.01
LW60-0.50-166-TPED	0.50	30.51	1.10	60	2.36	286	11.26	166	2407	0.34	0.74	0.54	1.19
LW60-0.60-166-TPED	0.60	36.61	1.32	60	2.36	332	13.07	166	2407	0.4	0.88	0.62	1.36
LW90-1.34-166-TPED	1.34	81.77	2.95	90	3.54	341	13.43	166	2407	0.9	1.98	1.56	3.43
LW120-2.67-166-TPED	2.67	162.93	5.87	120	4.72	381	15.00	166	2407	1.8	3.96	3.24	7.13
LW140-5.30-166-TPED	5.30	323.43	11.66	140	5.51	521	20.51	166	2407	3.57	7.85	5.71	12.56
LW140-7.50-166-TPED	7.50	457.68	16.50	140	5.51	706	27.80	166	2407	5.06	11.13	7.44	16.37
LW203-13.40-166-TPED	13.40	817.72	29.48	203	7.99	642	25.28	166	2407	9.04	19.88	14.42	31.72

NINGBO EVOLUTION FIRE SAFETY EQUIPMENT CO., LTD.

ADDRESS

NO.2 TENGJIAO RD., ECONOMIC DEVELOPMENT ZONE,
YUYAO, ZHEJIANG, 315400, P.R.CHINA



+86 137 3840 4444



+86 574 6252 2288



info@EvolutionSafe.com



EvolutionCylinder.com

Refillable DOT Aluminum Gas Cylinder (T1) Beverage (Carbon Dioxide)

FOLLOW US ON



- Approval: DOT
- Standard: DOT-3AL
- Material: AA 6061
- Thread: Follow Technical Data Sheet(EVO-THREAD)
- Finish: Full Brushed/Polished/Powder Coat/Shot blaster with unpainted or painted crown
- Graphics: Labels and logos available upon request
- Valve: Valves installed upon request
- Accessories: Carrying handle, Caps&Collars are available upon request
- Note: Custom sizes are also available
or check our "Summary of Refillable Aluminum Gas Cylinder by Standard" for more size



DOT-3AL  U.S. Department of Transportation

SKU	Water Capacity			Diameter		Length		Service Pressure		CO2 Capacity		Weight	
	liters	cuin	lbs	mm	in	mm	in	bar	psi	kgs	lbs	kgs	lbs
LF-111.3-2015-1.20-DOT	1.20	73.23	2.64	111.3	4.38	214	8.43	139	2015	0.81	1.78	1.59	3.50
LF-111.3-2015-1.30-DOT	1.30	79.33	2.86	111.3	4.38	227	8.94	139	2015	0.88	1.93	1.66	3.65
LF-111.3-2015-1.40-DOT	1.40	85.43	3.08	111.3	4.38	240	9.45	139	2015	0.94	2.06	1.73	3.81
LF-111.3-2015-1.60-DOT	1.60	97.64	3.52	111.3	4.38	266	10.47	139	2015	1.08	2.37	1.86	4.09
LF-111.3-2015-1.70-DOT	1.70	103.74	3.74	111.3	4.38	279	10.98	139	2015	1.14	2.50	1.93	4.25

NINGBO EVOLUTION FIRE SAFETY EQUIPMENT CO., LTD.

ADDRESS

NO.2 TENGJIAO RD., ECONOMIC DEVELOPMENT ZONE,
YUYAO, ZHEJIANG, 315400, P.R.CHINA



+86 137 3840 4444



+86 574 6252 2288



info@EvolutionSafe.com



EvolutionCylinder.com



Refillable TPED Steel Gas Cylinder (T1) Beverage

FOLLOW US ON   

- Approval: TPED from TUV SUD
- Standard: ISO 9809-1
- Material: 34CrMo4
- Thread: Follow Technical Data Sheet(EVO-THREAD)
- Finish: Polished/Powder Coat/Shot blaster with unpainted or painted crown
- Graphics: Labels and logos available upon request
- Valve: Valves installed upon request
- Accessories: Carrying handle, Caps&Collars are available upon request
- Note: Custom sizes are also available
or check our "Summary of Refillable Steel Gas Cylinder by Standard" for more size



TPED ISO 9809-1

SKU	Water Capacity			Diameter		Length		Service Pressure		CO2 Capacity		Weight	
	liters	cuin	lbs	mm	in	mm	in	bar	psi	kgs	lbs	kgs	lbs
BXT104-2.00-210-2.55-A	2.00	122.05	4.40	104	4.09	342	13.46	210	3045	1.50	3.30	3.08	6.78
BXT104-3.00-210-2.55-A	3.00	183.07	6.60	104	4.09	475	18.70	210	3045	2.25	4.95	3.74	8.23
BXT116-3.00-210-2.58-A	3.00	183.07	6.60	116	4.57	387	15.24	210	3045	2.25	4.95	3.96	8.71
BXT116-5.00-210-2.58-A	5.00	305.12	11.00	116	4.57	601	23.66	210	3045	3.70	8.14	4.88	10.74
BXT136-5.00-210-3.01-A	5.00	305.12	11.00	136	5.35	466	18.35	210	3045	3.70	8.14	6.45	14.19
BXT140-5.00-300-4.50-T	5.00	305.12	11.00	140	5.51	462	18.19	300	4350	3.70	8.14	8.20	18.04
BXT136-6.70-210-3.01-A	6.70	408.86	14.74	136	5.35	595	23.43	210	3045	5.00	11.00	7.83	17.23
BXT154-6.70-166.7-3.14-A	6.70	408.86	14.74	154	6.06	479	18.86	166.7	2418	4.50	9.90	8.12	17.86
BXT136-8.00-210-3.01-A	8.00	488.19	17.60	136	5.35	693	27.28	210	3045	6.00	13.20	8.73	19.21
BXT154-8.00-210-3.40-A	8.00	488.19	17.60	154	6.06	562	22.13	210	3045	6.00	13.20	9.21	20.26
BXT154-8.00-166.7-3.14-A	8.00	488.19	17.60	154	6.06	557	21.93	166.7	2418	5.40	11.88	9.03	19.87
BXT136-8.47-210-3.01-A	8.47	516.87	18.63	136	5.35	725	28.54	210	3045	6.30	13.86	9.14	20.11
BXT154-8.47-210-3.40-A	8.47	516.87	18.63	154	6.06	580	22.83	210	3045	6.30	13.86	9.57	21.05
BXT154-8.47-166.7-3.14-A	8.47	516.87	18.63	154	6.06	585	23.03	166.7	2418	5.70	12.54	9.36	20.59
BXT136-10.00-210-3.01-A	10.00	610.24	22.00	136	5.35	844	33.23	210	3045	7.50	16.50	10.27	22.59
BXT154-10.00-210-3.40-A	10.00	610.24	22.00	154	6.06	688	27.09	210	3045	7.50	16.50	10.83	23.83
BXT154-10.00-166.7-3.14-A	10.00	610.24	22.00	154	6.06	676	26.61	166.7	2418	6.70	14.74	10.43	22.95
BXT154-13.40-210-3.40-A	13.40	817.72	29.48	154	6.06	888	34.96	210	3045	10.00	22.00	13.34	29.35
BXT154-13.40-166.7-3.14-A	13.40	817.72	29.48	154	6.06	879	34.61	166.7	2418	9.00	19.80	12.81	28.18
BXT154-14.00-210-3.40-A	14.00	854.33	30.80	154	6.06	923	36.34	210	3045	10.50	23.10	13.79	30.34
BXT154-14.00-166.7-3.14-A	14.00	854.33	30.80	154	6.06	915	36.02	166.7	2418	9.40	20.68	13.24	29.13
BXT203-10.70-200-4.60-A	10.70	652.95	23.54	203	7.99	490	19.29	200	2900	8.00	17.60	17.20	37.84
BXT203-13.40-200-4.60-A	13.40	817.72	29.48	203	7.99	581	22.87	200	2900	10.00	22.00	20.00	44.00
BXT203-16.00-200-4.60-A	16.00	976.38	35.20	203	7.99	672	26.46	200	2900	12.00	26.40	22.50	49.50
BXT203-26.70-200-4.60-A	26.70	1629.34	58.74	203	7.99	1045	41.14	200	2900	20.00	44.00	33.40	73.48

NINGBO EVOLUTION FIRE SAFETY EQUIPMENT CO., LTD.

ADDRESS

NO.2 TENGJIAO RD., ECONOMIC DEVELOPMENT ZONE,
YUYAO, ZHEJIANG, 315400, P.R.CHINA



+86 137 3840 4444



+86 574 6252 2288



info@EvolutionSafe.com



EvolutionCylinder.com



Refillable TPED Aluminum Gas Cylinder (T1) Medical (Oxygen)

FOLLOW US ON



- Approval: TPED from TUV Rheinland
- Standard: ISO 7866
- Material: AA 6061
- Thread: Follow Technical Data Sheet(EVO-THREAD)
- Finish: Full Brushed/Polished/Powder Coat/Shot blaster with unpainted or painted crown
- Graphics: Labels and logos available upon request
- Valve: Valves installed upon request
- Accessories: Carrying handle, Caps&Collars are available upon request
- Note: Custom sizes are also available
or check our "Summary of Refillable Aluminum Gas Cylinder by Standard" for more size



TPED ISO 7866  TÜVRheinland®

SKU	Water Capacity			Diameter		Length		Service Pressure		Oxygen Capacity		Weight	
	liters	cuin	lbs	mm	in	mm	in	bar	psi	liters	cuft	kgs	lbs
LW60-0.50-166-TPED	0.50	30.51	1.10	60.0	2.36	286	11.26	166	2407	81.9	2.89	0.54	1.19
LW60.5-0.40-200-TPED	0.40	24.41	0.88	60.5	2.38	242	9.53	200	2900	79	2.79	0.62	1.36
LW60.5-0.50-200-TPED	0.50	30.51	1.10	60.5	2.38	290	11.42	200	2900	98.7	3.48	0.72	1.58
LW90-0.70-166-TPED	0.70	42.72	1.54	90.0	3.54	207	8.15	166	2407	114.7	4.05	1.01	2.22
LW90-1.00-166-TPED	1.00	61.02	2.20	90.0	3.54	270	10.63	166	2407	163.8	5.78	1.27	2.79
LW90-1.40-166-TPED	1.40	85.43	3.08	90.0	3.54	354	13.94	166	2407	229.4	8.10	1.61	3.54
LW90-1.00-200-TPED	1.00	61.02	2.20	90.0	3.54	280	11.02	200	2900	197.4	6.97	1.46	3.21
LW90-1.50-200-TPED	1.50	91.54	3.30	90.0	3.54	387	15.24	200	2900	296.1	10.45	1.96	4.31
LW120-2.00-166-TPED	2.00	122.05	4.40	120.0	4.72	303	11.93	166	2407	327.7	11.57	2.69	5.92
LW120-2.80-166-TPED	2.80	170.87	6.16	120.0	4.72	396	15.59	166	2407	458.7	16.19	3.35	7.37
LW120-3.20-166-TPED	3.20	195.28	7.04	120.0	4.72	442	17.40	166	2407	524.3	18.51	3.67	8.07
LW140-4.00-166-TPED	4.00	244.10	8.80	140.0	5.51	412	16.22	166	2407	655.3	23.13	4.68	10.30
LW140-6.30-166-TPED	6.30	384.45	13.86	140.0	5.51	605	23.82	166	2407	1032.1	36.43	6.49	14.28
LW184-8.00-166-TPED	8.00	488.19	17.60	184.0	7.24	490	19.29	166	2407	1310.6	46.26	9.18	20.20
LW184-10.00-166-TPED	10.00	610.24	22.00	184.0	7.24	586	23.07	166	2407	1638.3	57.83	10.72	23.58
LW203-12.00-166-TPED	12.00	732.29	26.40	203.0	7.99	586	23.07	166	2407	1966	69.40	13.33	29.33
LW203-20.00-166-TPED	20.00	1220.48	44.00	203.0	7.99	906	35.67	166	2407	3276.6	115.66	19.56	43.03

NINGBO EVOLUTION FIRE SAFETY EQUIPMENT CO., LTD.

ADDRESS

NO.2 TENGJIAO RD., ECONOMIC DEVELOPMENT ZONE,
YUYAO, ZHEJIANG, 315400, P.R.CHINA



+86 137 3840 4444



+86 574 6252 2288



info@EvolutionSafe.com



EvolutionCylinder.com



Refillable DOT Aluminum Gas Cylinder (T1) Medical (Oxygen)

FOLLOW US ON



- Approval: DOT
- Standard: DOT-3AL
- Material: AA 6061
- Thread: Follow Technical Data Sheet(EVO-THREAD)
- Finish: Full Brushed/Polished/Powder Coat/Shot blaster with unpainted or painted crown
- Graphics: Labels and logos available upon request
- Valve: Valves installed upon request
- Accessories: Carrying handle, Caps&Collars are available upon request
- Note: Custom sizes are also available
or check our "Summary of Refillable Aluminum Gas Cylinder by Standard" for more size



DOT-3AL  U.S. Department of Transportation

SKU	Water Capacity			Diameter		Length		Service Pressure		Oxygen Capacity		Weight	
	liters	cuin	lbs	mm	in	mm	in	bar	psi	liters	cuft	kgs	lbs
LF-81.5-2216-0.7-DOT	0.70	42.72	1.54	81.5	3.21	240	9.45	153	2216	105.7	3.73	0.88	1.94
LF-81.5-2216-1.00-DOT	1.00	61.02	2.20	81.5	3.21	310	12.20	153	2216	151	5.33	1.09	2.40
LF-90-3000-1.00-DOT	1.00	61.02	2.20	90	3.54	280	11.02	207	3000	204.3	7.21	1.56	3.43
LF-90-3000-1.50-DOT	1.50	91.54	3.30	90	3.54	390	15.35	207	3000	306.4	10.82	2.10	4.62
LF-111.3-2015-1.20-DOT	1.20	73.23	2.64	111.3	4.38	214	8.43	139	2015	164.6	5.81	1.59	3.50
LF-111.3-2015-1.40-DOT	1.40	85.43	3.08	111.3	4.38	240	9.45	139	2015	192.1	6.78	1.73	3.81
LF-111.3-2015-1.70-DOT	1.70	103.74	3.74	111.3	4.38	279	10.98	139	2015	233.2	8.23	1.93	4.25
LF-133.4-2216-3.90-DOT	3.90	237.99	8.58	133.4	5.25	430	16.93	153	2216	588.9	20.79	4.10	9.02
LF-133.4-2216-5.80-DOT	5.80	353.94	12.76	133.4	5.25	605	23.82	153	2216	875.8	30.92	5.59	12.30

NINGBO EVOLUTION FIRE SAFETY EQUIPMENT CO., LTD.

ADDRESS

NO.2 TENGJIAO RD., ECONOMIC DEVELOPMENT ZONE,
YUYAO, ZHEJIANG, 315400, P.R.CHINA



+86 137 3840 4444



+86 574 6252 2288



info@EvolutionSafe.com



EvolutionCylinder.com



Refillable TPED Steel Gas Cylinder (T1) Medical (O2)

FOLLOW US ON   

- Approval: TPED from TUV SUD
- Standard: ISO 9809-1
- Material: 34CrMo4
- Thread: Follow Technical Data Sheet(EVO-THREAD)
- Finish: Polished/Powder Coat/Shot blaster with unpainted or painted crown
- Graphics: Labels and logos available upon request
- Valve: Valves installed upon request
- Accessories: Carrying handle, Caps&Collars are available upon request
- Note: Custom sizes are also available
or check our "Summary of Refillable Steel Gas Cylinder by Standard" for more size



TPED ISO 9809-1

SKU	Water Capacity			Diameter		Length		Service Pressure		Oxygen Capacity		Weight	
	liters	cuin	lbs	mm	in	mm	in	bar	psi	liters	cuft	kgs	lbs
BXT104-2.00-210-2.55-A	2.00	122.05	4.40	104	4.09	342	13.46	210	3045	414.50	14.63	3.08	6.78
BXT104-3.00-210-2.55-A	3.00	183.07	6.60	104	4.09	475	18.70	210	3045	621.80	21.95	3.74	8.23
BXT116-3.00-210-2.58-A	3.00	183.07	6.60	116	4.57	387	15.24	210	3045	621.80	21.95	3.96	8.71
BXT116-5.00-210-2.58-A	5.00	305.12	11.00	116	4.57	601	23.66	210	3045	1036.30	36.58	4.88	10.74
BXT136-5.00-210-3.01-A	5.00	305.12	11.00	136	5.35	466	18.35	210	3045	1036.30	36.58	6.45	14.19
BXT140-5.00-300-4.50-T	5.00	305.12	11.00	140	5.51	462	18.19	300	4350	1480.40	52.26	8.20	18.04
BXT136-6.70-210-3.01-A	6.70	408.86	14.74	136	5.35	595	23.43	210	3045	1388.60	49.02	7.83	17.23
BXT154-6.70-166.7-3.14-A	6.70	408.86	14.74	154	6.06	479	18.86	166.7	2418	1102.30	38.91	8.12	17.86
BXT136-8.00-210-3.01-A	8.00	488.19	17.60	136	5.35	693	27.28	210	3045	1658.00	58.53	8.73	19.21
BXT154-8.00-210-3.40-A	8.00	488.19	17.60	154	6.06	562	22.13	210	3045	1658.00	58.53	9.21	20.26
BXT154-8.00-166.7-3.14-A	8.00	488.19	17.60	154	6.06	557	21.93	166.7	2418	1316.20	46.46	9.03	19.87
BXT136-8.47-210-3.01-A	8.47	516.87	18.63	136	5.35	725	28.54	210	3045	1755.40	61.97	9.14	20.11
BXT154-8.47-210-3.40-A	8.47	516.87	18.63	154	6.06	580	22.83	210	3045	1755.40	61.97	9.57	21.05
BXT154-8.47-166.7-3.14-A	8.47	516.87	18.63	154	6.06	585	23.03	166.7	2418	1393.50	49.19	9.36	20.59
BXT136-10.00-210-3.01-A	10.00	610.24	22.00	136	5.35	844	33.23	210	3045	2072.50	73.16	10.27	22.59
BXT154-10.00-210-3.40-A	10.00	610.24	22.00	154	6.06	688	27.09	210	3045	2072.50	73.16	10.83	23.83
BXT154-10.00-166.7-3.14-A	10.00	610.24	22.00	154	6.06	676	26.61	166.7	2418	1645.20	58.08	10.43	22.95
BXT154-13.40-210-3.40-A	13.40	817.72	29.48	154	6.06	888	34.96	210	3045	2777.20	98.04	13.34	29.35
BXT154-13.40-166.7-3.14-A	13.40	817.72	29.48	154	6.06	879	34.61	166.7	2418	2204.60	77.82	12.81	28.18
BXT154-14.00-210-3.40-A	14.00	854.33	30.80	154	6.06	923	36.34	210	3045	2901.60	102.43	13.79	30.34
BXT154-14.00-166.7-3.14-A	14.00	854.33	30.80	154	6.06	915	36.02	166.7	2418	2303.30	81.31	13.24	29.13

NINGBO EVOLUTION FIRE SAFETY EQUIPMENT CO., LTD.

ADDRESS

NO.2 TENGJIAO RD., ECONOMIC DEVELOPMENT ZONE,
YUYAO, ZHEJIANG, 315400, P.R.CHINA

 +86 137 3840 4444

 +86 574 6252 2288

 info@EvolutionSafe.com

 EvolutionCylinder.com



Refillable TPED & DOT Aluminum Gas Cylinder (T1) SCBA

FOLLOW US ON



- Approval: TPED & DOT
- Standard: ISO 7866 & DOT-3AL
- Material: AA 6061
- Thread: Follow Technical Data Sheet(EVO-THREAD)
- Finish: Full Brushed/Polished/Powder Coat/Shot blaster with unpainted or painted crown
- Graphics: Labels and logos available upon request
- Valve: Valves installed upon request
- Note: Custom sizes are also available
or check our "Summary of Refillable Aluminum Gas Cylinder by Standard" for more size



TPED ISO 7866 TÜVRheinland®

SKU	Water Capacity			Diameter		Length		Service Pressure		Oxygen Capacity		Weight	
	liters	cuin	lbs	mm	in	mm	in	bar	psi	liters	cuft	kgs	lbs
LW90-1.00-200-TPED	1.00	61.02	2.20	90	3.54	280	11.02	200	2900	197.4	6.97	1.46	3.21

DOT-3AL U.S.Department of transportation

SKU	Water Capacity			Diameter		Length		Service Pressure		Oxygen Capacity		Weight	
	liters	cuin	lbs	mm	in	mm	in	bar	psi	liters	cuft	kgs	lbs
LF-90-3000-1.30-DOT	1.30	79.33	2.86	90	3.54	346	13.62	207	3000	265.6	9.38	1.88	4.14

NINGBO EVOLUTION FIRE SAFETY EQUIPMENT CO., LTD.

ADDRESS

NO.2 TENGJIAO RD., ECONOMIC DEVELOPMENT ZONE,
YUYAO, ZHEJIANG, 315400, P.R.CHINA



+86 137 3840 4444



+86 574 6252 2288



info@EvolutionSafe.com



EvolutionCylinder.com



Refillable TPED Steel Gas Cylinder (T1)

SCBA

FOLLOW US ON



- Approval: TPED from TUV SUD
- Standard: ISO 9809-1
- Material: 34CrMo4
- Thread: Follow Technical Data Sheet(EVO-THREAD)
- Finish: Polished/Powder Coat/Shot blaster with unpainted or painted crown
- Graphics: Labels and logos available upon request
- Valve: Valves installed upon request
- Accessories: Carrying handle, Caps&Collars are available upon request
- Note: Custom sizes are also available
or check our "Summary of Refillable Steel Gas Cylinder by Standard" for more size



TPED ISO 9809-1

SKU	Water Capacity			Diameter		Length		Service Pressure		Oxygen Capacity		Weight	
	liters	cuin	lbs	mm	in	mm	in	bar	psi	liters	cuft	kgs	lbs
BXT104-2.00-210-2.55-A	2.00	122.05	4.40	104	4.09	342	13.46	210	3045	414.50	14.63	3.08	6.78
BXT104-3.00-210-2.55-A	3.00	183.07	6.60	104	4.09	475	18.70	210	3045	621.80	21.95	3.74	8.23
BXT116-3.00-210-2.58-A	3.00	183.07	6.60	116	4.57	387	15.24	210	3045	621.80	21.95	3.96	8.71
BXT136-6.00-210-3.01-A	6.00	366.14	13.20	136	5.35	542	21.34	210	3045	1243.50	43.90	7.31	16.08
BXT140-6.00-300-4.50-T	6.00	366.14	13.20	140	5.51	545	21.46	300	4350	1776.50	62.71	9.65	21.23
BXT136-6.80-210-3.01-A	6.80	414.96	14.96	136	5.35	602	23.70	210	3045	1409.30	49.75	7.90	17.38
BXT140-6.80-300-4.50-T	6.80	414.96	14.96	140	5.51	611	24.06	300	4350	2013.30	71.07	10.81	23.78
BXT136-7.00-210-3.01-A	7.00	427.17	15.40	136	5.35	617	24.29	210	3045	1450.80	51.21	8.04	17.69
BXT140-7.00-300-4.50-T	7.00	427.17	15.40	140	5.51	628	24.72	300	4350	2072.50	73.16	11.10	24.42

NINGBO EVOLUTION FIRE SAFETY EQUIPMENT CO., LTD.

ADDRESS

NO.2 TENGJIAO RD., ECONOMIC DEVELOPMENT ZONE,
YUYAO, ZHEJIANG, 315400, P.R.CHINA



+86 137 3840 4444



+86 574 6252 2288



info@EvolutionSafe.com



EvolutionCylinder.com



Refillable TPED Aluminum Gas Cylinder (T1) SCUBA

FOLLOW US ON   

- Approval: TPED from TÜV Rheinland
- Standard: ISO 7866
- Material: AA 6061
- Thread: Follow Technical Data Sheet(EVO-THREAD)
- Finish: Full Brushed/Polished/Powder Coat/Shot blaster with unpainted or painted crown
- Graphics: Labels and logos available upon request
- Valve: Valves installed upon request
- Accessories: Carrying handle, Caps&Collars are available upon request
- Note: Custom sizes are also available
or check our "Summary of Refillable Aluminum Gas Cylinder by Standard" for more size



TPED ISO 7866  TÜVRheinland®

SKU	Water Capacity			Diameter		Length		Service Pressure		Oxygen Capacity		Weight		Buoyancy kgs		
	liters	cuin	lbs	mm	in	mm	in	bar	psi	liters	cuft	kgs	lbs	full	half	empty
LW60.5-0.35-200-TPED	0.35	21.36	0.77	60.5	2.38	218	8.58	200	2900	69.1	2.44	0.57	1.25	-0.18	-0.13	-0.08
LW60.5-0.40-200-TPED	0.40	24.41	0.88	60.5	2.38	242	9.53	200	2900	79	2.79	0.62	1.36	-0.18	-0.12	-0.07
LW60.5-0.50-200-TPED	0.50	30.51	1.10	60.5	2.38	290	11.42	200	2900	98.7	3.48	0.72	1.58	-0.17	-0.10	-0.03
LW60.5-0.60-200-TPED	0.60	36.61	1.32	60.5	2.38	338	13.31	200	2900	118.4	4.18	0.82	1.80	-0.16	-0.07	0.01
LW60.5-0.70-200-TPED	0.70	42.72	1.54	60.5	2.38	386	15.20	200	2900	138.2	4.88	0.92	2.02	-0.14	-0.04	0.05
LW90-0.70-200-TPED	0.70	42.72	1.54	90.0	3.54	216	8.50	200	2900	138.2	4.88	1.16	2.55	-0.29	-0.19	-0.09
LW90-0.80-200-TPED	0.80	48.82	1.76	90.0	3.54	237	9.33	200	2900	157.9	5.57	1.26	2.77	-0.28	-0.17	-0.06
LW90-1.00-200-TPED	1.00	61.02	2.20	90.0	3.54	280	11.02	200	2900	197.4	6.97	1.46	3.21	-0.26	-0.12	0.01
LW90-1.50-200-TPED	1.50	91.54	3.30	90.0	3.54	387	15.24	200	2900	296.1	10.45	1.96	4.31	-0.23	-0.02	0.19

NINGBO EVOLUTION FIRE SAFETY EQUIPMENT CO., LTD.

ADDRESS

NO.2 TENGJIAO RD., ECONOMIC DEVELOPMENT ZONE,
YUYAO, ZHEJIANG, 315400, P.R.CHINA



+86 137 3840 4444



+86 574 6252 2288



info@EvolutionSafe.com



EvolutionCylinder.com



Refillable DOT Aluminum Gas Cylinder (T1) SCUBA

FOLLOW US ON   

- Approval: DOT
- Standard: DOT-3AL
- Material: AA 6061
- Thread: Follow Technical Data Sheet(EVO-THREAD)
- Finish: Full Brushed/Polished/Powder Coat/Shot blaster with unpainted or painted crown
- Graphics: Labels and logos available upon request
- Valve: Valves installed upon request
- Accessories: Carrying handle, Caps&Collars are available upon request
- Note: Custom sizes are also available
or check our "Summary of Refillable Aluminum Gas Cylinder by Standard" for more size



DOT-3AL  U.S. Department of Transportation

SKU	Water Capacity			Diameter		Length		Service Pressure		Oxygen Capacity		Weight		Buoyancy lbs		
	liters	cuin	lbs	mm	in	mm	in	bar	psi	liters	cuft	kgs	lbs	full	500 psi	empty
LF-61-3000-0.40-DOT	0.40	24.41	0.88	61.0	2.40	250	9.84	207	3000	81.7	2.88	0.61	1.34	-0.31	-0.09	-0.04
LF-61-3000-0.50-DOT	0.50	30.51	1.10	61.0	2.40	298	11.73	207	3000	102.1	3.60	0.72	1.58	-0.29	-0.02	0.02
LF-61-3000-0.60-DOT	0.60	36.61	1.32	61.0	2.40	346	13.62	207	3000	122.6	4.33	0.83	1.83	-0.29	-0.02	0.02
LF-61-3000-0.70-DOT	0.70	42.72	1.54	61.0	2.40	394	15.51	207	3000	143	5.05	0.94	2.07	-0.29	0.07	0.15
LF-90-3000-1.00-DOT	1.00	61.02	2.20	90.0	3.54	280	11.02	207	3000	204.3	7.21	1.56	3.43	-0.84	-0.31	-0.20
LF-90-3000-1.50-DOT	1.50	91.54	3.30	90.0	3.54	390	15.35	207	3000	306.4	10.82	2.10	4.62	-0.79	-0.20	-0.07
LF-111.3-2015-1.50-DOT	1.50	91.54	3.00	111.3	4.38	266	10.47	139	2015	219.5	7.75	1.86	4.09	-0.20	0.33	0.44

NINGBO EVOLUTION FIRE SAFETY EQUIPMENT CO., LTD.

ADDRESS

NO.2 TENGJIAO RD., ECONOMIC DEVELOPMENT ZONE,
YUYAO, ZHEJIANG, 315400, P.R.CHINA



+86 137 3840 4444



+86 574 6252 2288



info@EvolutionSafe.com



EvolutionCylinder.com



Refillable TPED Steel Gas Cylinder (T1) SCUBA

FOLLOW US ON



- Approval: TPED from TUV SUD
- Standard: ISO 9809-1
- Material: 34CrMo4
- Thread: Follow Technical Data Sheet(EVO-THREAD)
- Finish: Polished/Powder Coat/Shot blaster with unpainted or painted crown
- Graphics: Labels and logos available upon request
- Valve: Valves installed upon request
- Accessories: Carrying handle, Caps&Collars are available upon request
- Note: Custom sizes are also available
or check our "Summary of Refillable Steel Gas Cylinder by Standard" for more size



TPED ISO 9809-1

SKU	Water Capacity			Diameter		Length		Service Pressure		Oxygen Capacity		Weight		Buoyancy lbs		
	liters	cu in	lbs	mm	in	mm	in	bar	psi	liters	cuft	kgs	lbs	full	half	empty
BXT104-2.00-210-2.55-A	2.00	122.05	4.40	104	4.09	342	13.46	210	3045	414.5	14.63	3.08	6.78	-1.08	-0.82	-0.54
BXT104-3.00-210-2.55-A	3.00	183.07	6.60	104	4.09	475	18.70	210	3045	621.8	21.95	3.74	8.23	-0.9	-0.48	-0.07
BXT116-3.00-210-2.58-A	3.00	183.07	6.60	116	4.57	387	15.24	210	3045	621.8	21.95	3.96	8.71	-1.17	-0.75	-0.34
BXT136-5.00-210-3.01-A	5.00	305.12	11.00	136	5.35	466	18.35	210	3045	1036.3	36.58	6.45	14.19	-1.75	-1.06	-0.37
BXT140-5.00-300-4.50-A	5.00	305.12	11.00	140	5.51	462	18.19	300	4350	1480.4	52.26	8.2	18.04	-4.04	-3.06	-2.07
BXT136-7.00-210-3.01-A	7.00	427.17	15.40	136	5.35	617	24.29	210	3045	1450.8	51.21	8.04	17.69	-1.7	-0.73	0.23
BXT140-7.00-300-4.50-A	7.00	427.17	15.40	140	5.51	628	24.72	300	4350	2072.5	73.16	11.1	24.42	-5.17	-3.79	-2.41
BXT154-10.00-210-3.40-A	10.00	610.24	22.00	154	6.06	688	27.09	210	3045	2072.5	73.16	10.83	23.83	-1.72	-0.34	1.04

NINGBO EVOLUTION FIRE SAFETY EQUIPMENT CO., LTD.

ADDRESS

NO.2 TENGJIAO RD., ECONOMIC DEVELOPMENT ZONE,
YUYAO, ZHEJIANG, 315400, P.R.CHINA



+86 137 3840 4444



+86 574 6252 2288



info@EvolutionSafe.com



EvolutionCylinder.com



Refillable TPED Aluminum Gas Cylinder (T1) Paintball

FOLLOW US ON



- Approval: TPED from TUV Rheinland
- Standard: ISO 7866
- Material: AA 6061
- Thread: Follow Technical Data Sheet(EVO-THREAD)
- Finish: Full Brushed/Polished/Powder Coat/Shot blaster with unpainted or painted crown
- Graphics: Labels and logos available upon request
- Valve: Valves installed upon request
- Note: Custom sizes are also available
or check our "Summary of Refillable Aluminum Gas Cylinder by Standard" for more size



TPED ISO 7866 TÜVRheinland®

SKU	Water Capacity			Diameter		Length		Service Pressure		CO2 Capacity		Weight	
	liters	cuin	lbs	mm	in	mm	in	bar	psi	kgs	oz	kgs	lbs
LW60.5-0.38-200-TPED	0.38	23.19	0.84	60.5	2.38	232	9.13	200	2900	0.25	8.81	0.60	1.32
LW60.5-0.40-200-TPED	0.40	24.41	0.88	60.5	2.38	242	9.53	200	2900	0.27	9.52	0.62	1.36
LW60.5-0.45-200-TPED	0.45	27.46	0.99	60.5	2.38	266	10.47	200	2900	0.30	10.58	0.67	1.47
LW60.5-0.50-200-TPED	0.50	30.51	1.10	60.5	2.38	290	11.42	200	2900	0.33	11.64	0.72	1.58
LW60.5-0.60-200-TPED	0.60	36.61	1.32	60.5	2.38	338	13.31	200	2900	0.40	14.10	0.82	1.80
LW60.5-0.70-200-TPED	0.70	42.72	1.54	60.5	2.38	386	15.20	200	2900	0.47	16.57	0.92	2.02
LW90-0.70-200-TPED	0.70	42.72	1.54	90	3.54	216	8.50	200	2900	0.47	16.57	1.16	2.55
LW90-0.80-200-TPED	0.80	48.82	1.76	90	3.54	237	9.33	200	2900	0.54	19.04	1.26	2.77
LW90-1.00-200-TPED	1.00	61.02	2.20	90	3.54	280	11.02	200	2900	0.67	23.63	1.46	3.21

NINGBO EVOLUTION FIRE SAFETY EQUIPMENT CO., LTD.

ADDRESS

NO.2 TENGJIAO RD., ECONOMIC DEVELOPMENT ZONE,
YUYAO, ZHEJIANG, 315400, P.R.CHINA



+86 137 3840 4444



+86 574 6252 2288



info@EvolutionSafe.com



EvolutionCylinder.com



Refillable DOT Aluminum Gas Cylinder (T1) Paintball

FOLLOW US ON   

- Approval: DOT
- Standard: DOT-3AL
- Material: AA 6061
- Thread: Follow Technical Data Sheet(EVO-THREAD)
- Finish: Full Brushed/Polished/Powder Coat/Shot blaster with unpainted or painted crown
- Graphics: Labels and logos available upon request
- Valve: Valves installed upon request
- Note: Custom sizes are also available
or check our "Summary of Refillable Aluminum Gas Cylinder by Standard" for more size



DOT-3AL  U.S. Department of Transportation

SKU	Water Capacity			Diameter		Length		Service Pressure		CO2 Capacity		Weight	
	liters	cuin	lbs	mm	in	mm	in	bar	psi	kgs	oz	kgs	lbs
LF-61-3000-0.40-DOT	0.40	24.41	0.88	61	2.40	250	9.84	207	3000	0.27	9.52	0.61	1.34
LF-61-3000-0.45-DOT	0.45	27.46	0.99	61	2.40	274	10.79	207	3000	0.30	10.58	0.66	1.45
LF-61-3000-0.50-DOT	0.50	30.51	1.10	61	2.40	298	11.73	207	3000	0.33	11.64	0.72	1.58
LF-61-3000-0.60-DOT	0.60	36.61	1.32	61	2.40	346	13.62	207	3000	0.40	14.10	0.83	1.83
LF-61-3000-0.70-DOT	0.70	42.72	1.54	61	2.40	394	15.51	207	3000	0.47	16.57	0.94	2.07
LF-90-3000-1.00-DOT	1.00	61.02	2.20	90	3.54	280	11.02	207	3000	0.67	23.63	1.56	3.43

NINGBO EVOLUTION FIRE SAFETY EQUIPMENT CO., LTD.

ADDRESS

NO.2 TENGJIAO RD., ECONOMIC DEVELOPMENT ZONE,
YUYAO, ZHEJIANG, 315400, P.R.CHINA



+86 137 3840 4444



+86 574 6252 2288



info@EvolutionSafe.com



EvolutionCylinder.com

Refillable TPED & DOT Aluminum Gas Cylinder (T1) Nitrous Oxide (Performance Racing)

FOLLOW US ON   

- Approval: TPED & DOT
- Standard: ISO 7866 & DOT-3AL
- Material: AA 6061
- Thread: Follow Technical Data Sheet(EVO-THREAD)
- Finish: Full Brushed/Polished/Powder Coat/Shot blaster with unpainted or painted crown
- Graphics: Labels and logos available upon request
- Valve: Valves installed upon request
- Accessories: Carrying handle, Caps&Collars are available upon request
- Note: Custom sizes are also available
or check our "Summary of Refillable Aluminum Gas Cylinder by Standard" for more size



TPED ISO 7866 TÜVRheinland®

SKU	Water Capacity			Diameter		Length		Service Pressure		N2O Capacity		Weight	
	liters	cuin	lbs	mm	in	mm	in	bar	psi	kgs	lbs	kgs	lbs
LW90-0.80-166-TPED	0.80	48.82	1.76	90	3.54	228	8.98	166	2407	0.54	1.20	1.10	2.42
LW90-1.10-166-TPED	1.10	67.13	2.42	90	3.54	270	10.63	166	2407	0.75	1.65	1.27	2.79
LW90-1.20-166-TPED	1.20	73.23	2.64	90	3.54	312	12.28	166	2407	0.82	1.80	1.44	3.17
LW90-1.30-166-TPED	1.30	79.33	2.86	90	3.54	333	13.11	166	2407	0.88	1.94	1.52	3.34
LW120-1.70-166-TPED	1.70	103.74	3.74	120	4.72	268	10.55	166	2407	1.16	2.54	2.44	5.37
LW120-3.40-166-TPED	3.40	207.48	7.48	120	4.72	466	18.35	166	2407	2.31	5.09	3.84	8.45
LW140-6.70-166-TPED	6.70	408.86	14.74	140	5.51	639	25.16	166	2407	4.56	10.02	6.81	14.98
LW184-10.00-166-TPED	10.00	610.24	22.00	184	7.24	586	23.07	166	2407	6.80	14.96	10.72	23.58
LW184-13.40-166-TPED	13.40	817.72	29.48	184	7.24	749	29.49	166	2407	9.11	20.05	13.34	29.35

DOT-3AL U.S. Department of Transportation

SKU	Water Capacity			Diameter		Length		Service Pressure		N2O Capacity		Weight	
	liters	cuin	lbs	mm	in	mm	in	bar	psi	kgs	lbs	kgs	lbs
EVO-LW-133-3.40-1800-DOT	3.40	207.48	7.48	133	5.24	360	14.17	124	1800	2.31	5.09	3.09	6.80
EVO-LW-175-6.70-1800-DOT	6.70	408.86	14.74	175	6.89	425	16.73	124	1800	4.56	10.02	6.38	14.04
EVO-LW-175-10.00-1800-DOT	10.00	610.24	22.00	175	6.89	596	23.46	124	1800	6.80	14.96	8.31	18.28
EVO-LW-203-13.40-1800-DOT	13.40	817.72	29.48	203	7.99	600	23.62	124	1800	9.11	20.05	11.38	25.04

NINGBO EVOLUTION FIRE SAFETY EQUIPMENT CO., LTD.

ADDRESS

NO.2 TENGJIAO RD., ECONOMIC DEVELOPMENT ZONE,
YUYAO, ZHEJIANG, 315400, P.R.CHINA



+86 137 3840 4444



+86 574 6252 2288



info@EvolutionSafe.com



EvolutionCylinder.com

Refillable TPED Steel Gas Cylinder (T1) Nitrous Oxide (Performance Racing)

FOLLOW US ON   

- Approval: TPED from TUV SUD
- Standard: ISO 9809-1
- Material: 34CrMo4
- Thread: Follow Technical Data Sheet(EVO-THREAD)
- Finish: Polished/Powder Coat/Shot blaster with unpainted or painted crown
- Graphics: Labels and logos available upon request
- Valve: Valves installed upon request
- Accessories: Carrying handle, Caps&Collars are available upon request
- Note: Custom sizes are also available
or check our "Summary of Refillable Steel Gas Cylinder by Standard" for more size



TPED ISO 9809-1

SKU	Water Capacity			Diameter		Length		Service Pressure		N2O Capacity		Weight	
	liters	cuin	lbs	mm	in	mm	in	bar	psi	kgs	lbs	kgs	lbs
BXT104-3.40-210-2.55-A	3.40	207.48	7.48	104	4.09	528	20.79	210	3045	2.31	5.09	4.07	8.95
BXT154-6.70-166.7-3.14-A	6.70	408.86	14.74	154	6.06	479	18.86	166.7	2418	4.56	10.02	8.12	17.86
BXT154-10.00-166.7-3.14-A	10.00	610.24	22.00	154	6.06	676	26.61	166.7	2418	6.80	14.96	10.43	22.95
BXT154-13.40-166.7-3.14-A	13.40	817.72	29.48	154	6.06	879	34.61	166.7	2418	9.11	20.05	12.81	28.18

NINGBO EVOLUTION FIRE SAFETY EQUIPMENT CO., LTD.

ADDRESS

NO.2 TENGJIAO RD., ECONOMIC DEVELOPMENT ZONE,
YUYAO, ZHEJIANG, 315400, P.R.CHINA



+86 137 3840 4444



+86 574 6252 2288



info@EvolutionSafe.com



EvolutionCylinder.com

Unit: $\frac{\text{in}}{(\text{mm})}$

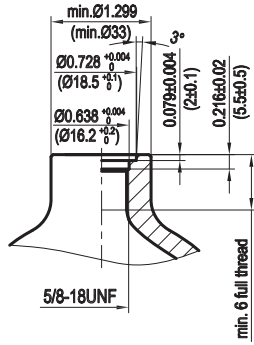

0.625-18UNF / ASME B1.1

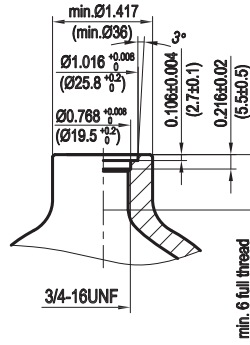

0.75-16UNF / ASME B1.1

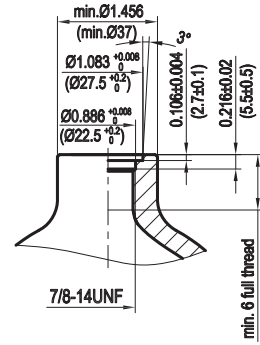

0.875-14UNF / ASME B1.1

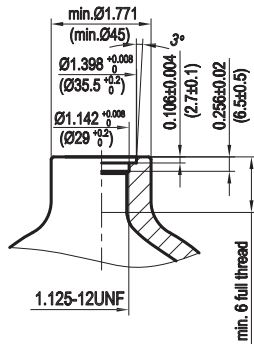

1.125-12UNF / ASME B1.1

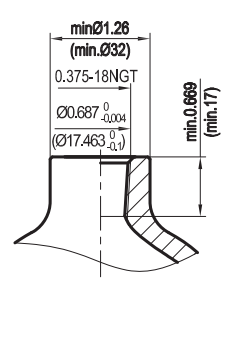

0.375-18NGT / CGA V-1

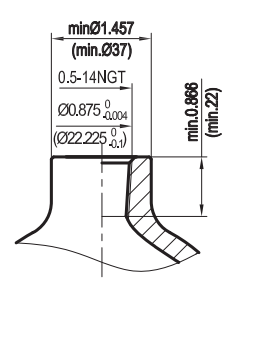

0.5-14NGT / CGA V-1

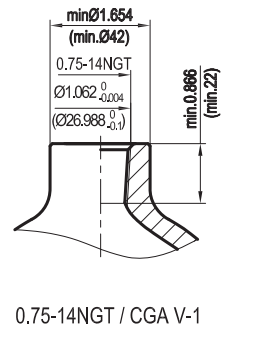

0.75-14NGT / CGA V-1

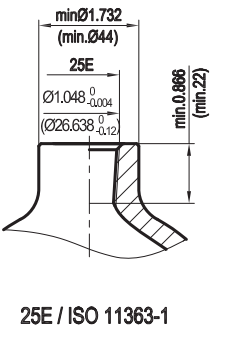

25E / ISO 11363-1

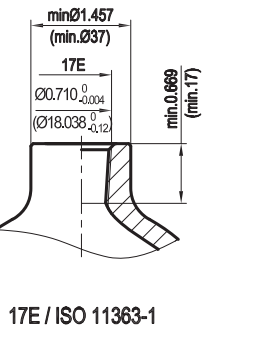

17E / ISO 11363-1

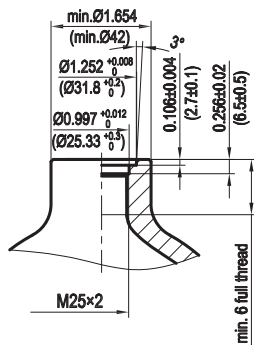

M25x2 / ISO 15245

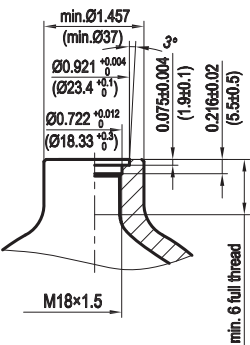

M18x1.5 / ISO 15245

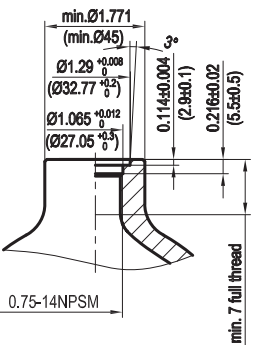

0.75-14NPSM / ANSI B57.1

NINGBO EVOLUTION FIRE SAFETY EQUIPMENT CO., LTD.

ADD: NO.2 TENGJIAO RD., ECONOMIC DEVELOPMENT ZONE, YUYAO, ZHEJIANG, 315400, P.R.CHINA

T: +86 574 6252 2288 **E:** info@EvolutionSafe.com

FIRE FIGHTING: www.EvolutionFire.com **PPE:** www.EvolutionSafe.com **GAS CYLINDER:** www.EvolutionCylinder.com